

ADDITIONAL INFORMATION AS REQUIRED BY SEC 51 (17) OF THE PLANNING ACT (1990)

- (a) AS SHOWN ON DRAFT PLAN
- (b) AS SHOWN
- (c) AS SHOWN
- (d) REFER TO THE SCHEDULE OF LAND USE
- (e) RESIDENTIAL & AGRICULTURAL
- (f) AS SHOWN ON DRAFT PLAN
- (g) AS SHOWN ON DRAFT PLAN
- (h) PRIVATE WELLS, PRIVATE SEPTICS
- (i) SOIL TYPES: SAND, GRAVEL, SILT
- (j) AS SHOWN ON DRAFT PLAN
- (k) MUNICIPAL SERVICES AVAILABLE: ELECTRICAL, TELEPHONE, GARBAGE COLLECTION, GAS
- (l) NONE

SHARPE LINE



DRAFT PLAN OF SUBDIVISION

IAN CAMERON RURAL
SUBDIVISION
CAVAN MONAGHAN TOWNSHIP
PLAN OF:
PROPOSED SUBDIVISION ON
PART OF LOT 12
CONCESSION 10
GEOGRAPHIC TOWNSHIP OF CAVAN
TOWNSHIP OF CAVAN MONAGHAN
COUNTY OF PETERBOROUGH

LAND USE SCHEDULE

LOT/BLOCK	AREA (ha)	FRONTAGE	INTENDED USE
1	0.36 ha	38.13	SINGLE DETACHED DWELLING
2	0.32 ha	38.01	SINGLE DETACHED DWELLING
3	0.33 ha	38.87	SINGLE DETACHED DWELLING
4	0.30 ha	47.70	SINGLE DETACHED DWELLING
5	0.42 ha	38.52	SINGLE DETACHED DWELLING
6	0.51 ha	38.00	SINGLE DETACHED DWELLING
7	0.36 ha	38.15	SINGLE DETACHED DWELLING
8	0.32 ha	38.07	SINGLE DETACHED DWELLING
9	0.34 ha	23.71	SINGLE DETACHED DWELLING
10	0.48 ha	23.66	SINGLE DETACHED DWELLING
11	0.52 ha	38.08	SINGLE DETACHED DWELLING
12	0.30 ha	38.00	SINGLE DETACHED DWELLING
13	0.31 ha	38.30	SINGLE DETACHED DWELLING
14	0.30 ha	38.18	SINGLE DETACHED DWELLING
15	0.32 ha	75.52	SINGLE DETACHED DWELLING
16	0.72 ha	-	ROAD
TOTAL SITE AREA			6.22ha

COUNTY ROAD #10

BENCHMARK - ELEVATION -
ADD BENCHMARK DESCRIPTION HERE

KEY PLAN

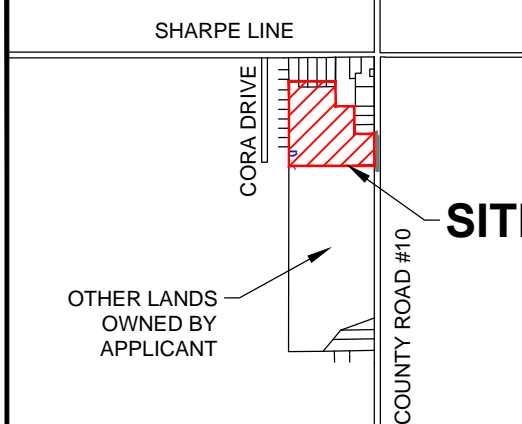

LEGEND

- PROPOSED BUILDING FOOTPRINT
- PROPOSED SEPTIC TANK
- PROPOSED RAISED BED SEPTIC
- LOT DRAINAGE ARROW
- ROAD DRAINAGE ARROW

OWNER'S CERTIFICATE

I AUTHORIZE KEVIN M. DUGUAY COMMUNITY PLANNING & CONSULTING INC. TO SUBMIT THIS DRAFT PLAN OF SUBDIVISION TO THE TOWNSHIP OF CAVAN MONAGHAN.

DATE: _____ IAN CAMERON

SURVEYOR'S CERTIFICATE

I CERTIFY THAT:

- THIS SURVEY AND PLAN ARE CORRECT AND ARE IN ACCORDANCE WITH THE SURVEYS ACT, THE SURVEYORS ACT AND THE LAND TITLES ACT AND THE REGULATIONS MADE UNDER THEM.
- THE SURVEY WAS COMPLETED ON NOVEMBER 12, 2014.

DATE: _____ CHRISTOPHER E. MUSCLOW
Ontario Land Surveyor

IAN CAMERON RURAL SUBDIVISION

TOWNSHIP OF CAVAN MONAGHAN

DRAFT PLAN OF SUBDIVISION

A	DATE	BY	REVISION
22-12-14	J.A.		FOR DRAFT PLAN SUBMISSION



DRAWN: J.ARMSTRONG

DESIGNED: J.ARMSTRONG

APPROVED: A.HILL

DATE: DECEMBER 22, 2014

SCALE: HORIZ: 1:750
VERT: -

PROJECT NO.: 14016
DRAWING FILE NO.: 14016-DP
SHT. NO.: 01